

Ordering Information

GETTING TICKETS

In Person

Ford Center Box Office

Hours: Noon-4 p.m. Monday-Friday
(except university holidays).

One hour prior to all Ford Center events.

UM Box Office (Ole Miss Student Union)

Hours: 10 a.m.-4 p.m. Monday-Friday
(except university holidays).

By Phone

Call 662-915-7411 from 10 a.m.-4 p.m.
Monday-Friday (except university holidays).

Online

Go to www.olemiss.edu/fordcenter or
www.olemiss.edu/depts/tickets.

FAMILY OR FRIEND SEATING

We will make every effort to seat you with friends or family. Simply include each individual ticket order in the same envelope for processing at the same time.



TICKET ORDER FORM

Please print all information.

NAME _____

ADDRESS _____

CITY _____ STATE _____ ZIP _____

PREFERRED PHONE _____ E-MAIL ADDRESS _____

- I am currently a member of the Friends of the Ford Center
- Enclosed is my new/renewed Friends membership
- Wheelchair access needed

All programs and dates are subject to change.

MAIL TO: UM BOX OFFICE
301B STUDENT UNION
UNIVERSITY, MS 38677-1848

(If you would like to be seated with family or friends, please include all ticket order forms in one envelope.)

PAYMENT INFORMATION

- Check payable to the Ford Center enclosed
- Charge Visa MasterCard

Account number _____ Expiration date _____

Name as it appears on card _____

Signature _____

- UM payroll deduction

Department _____

Employee ID _____ Office phone _____

GENERAL ADMISSION

Ford Series

An Evening with Marvin Hamlish, Sounds of Stage and Screen SEPTEMBER 04	<input type="checkbox"/> \$37	<input type="checkbox"/> \$33	<input type="checkbox"/> \$30	<input type="checkbox"/> \$40	<input type="checkbox"/> \$37				
Camelot NOVEMBER 24	<input type="checkbox"/> \$37	<input type="checkbox"/> \$33	<input type="checkbox"/> \$30	<input type="checkbox"/> \$40	<input type="checkbox"/> \$37				
Scrooge, In Concert DECEMBER 18	<input type="checkbox"/> \$37	<input type="checkbox"/> \$33	<input type="checkbox"/> \$30	<input type="checkbox"/> \$40	<input type="checkbox"/> \$37				
Cabaret FEBRUARY 13	<input type="checkbox"/> \$37	<input type="checkbox"/> \$33	<input type="checkbox"/> \$30	<input type="checkbox"/> \$40	<input type="checkbox"/> \$37				
The Glenn Miller Orchestra FEBRUARY 20	<input type="checkbox"/> \$37	<input type="checkbox"/> \$33	<input type="checkbox"/> \$30	<input type="checkbox"/> \$40	<input type="checkbox"/> \$37				
Shirley Jones, A Night at the Oscars MARCH 02	<input type="checkbox"/> \$37	<input type="checkbox"/> \$33	<input type="checkbox"/> \$30	<input type="checkbox"/> \$40	<input type="checkbox"/> \$37				
Ford Series Season Ticket	<input type="checkbox"/> \$165	<input type="checkbox"/> \$145	<input type="checkbox"/> \$130	<input type="checkbox"/> \$180	<input type="checkbox"/> \$165				
SUBTOTAL FOR FORD SERIES									

Series 108

Remember Me OCTOBER 27	<input type="checkbox"/> \$25								
The RFK Project FEBRUARY 19	<input type="checkbox"/> \$25								
Tao, The Martial Art of Drumming MARCH 03	<input type="checkbox"/> \$25								
SUBTOTAL FOR SERIES 108									

Family Friendly

Alice in Wonderland OCTOBER 03	<input type="checkbox"/> \$12							<input type="checkbox"/> \$6	
Raggs LIVE Dance Party! JANUARY 30	<input type="checkbox"/> \$12							<input type="checkbox"/> \$6	
The Adventures of Harold and the Purple Crayon APRIL 17	<input type="checkbox"/> \$12							<input type="checkbox"/> \$6	
SUBTOTAL FOR FAMILY FRIENDLY									

Limit 3 child tickets per each general admission ticket purchased

Artist Series

To Kill A Mockingbird OCTOBER 22	<input type="checkbox"/> \$28	<input type="checkbox"/> \$28	<input type="checkbox"/> \$20	<input type="checkbox"/> \$20					
IRIS Orchestra, featuring Jeremy Denk NOVEMBER 15	<input type="checkbox"/> \$28	<input type="checkbox"/> \$28	<input type="checkbox"/> \$20	<input type="checkbox"/> \$20					
American Spiritual Ensemble JANUARY 29	<input type="checkbox"/> \$28	<input type="checkbox"/> \$28	<input type="checkbox"/> \$20	<input type="checkbox"/> \$20					
Porgy and Bess MARCH 09	<input type="checkbox"/> \$28	<input type="checkbox"/> \$28	<input type="checkbox"/> \$20	<input type="checkbox"/> \$20					
Turtle Island Quartet/ Ying Quartet APRIL 16	<input type="checkbox"/> \$28	<input type="checkbox"/> \$28	<input type="checkbox"/> \$20	<input type="checkbox"/> \$20					
Artist Series Season Ticket	<input type="checkbox"/> \$108	<input type="checkbox"/> \$108	<input type="checkbox"/> not available	<input type="checkbox"/> not available					
SUBTOTAL FOR ARTIST SERIES									

Limit 3 child tickets per each general admission ticket purchased

Total Number of Tickets x 50¢ ticket fee* = \$ + SUBTOTAL \$ = \$ + \$3 Handling and mailing fee = \$

GRAND TOTAL \$

*Friends of the Ford Center are exempt from ticket fees.

*Friends of the Ford Center are exempt from ticket fees.

Seating Chart

ABOUT SECTIONS AND SEATING

Rows and Seat Numbers

- Rows are labeled alphabetically, starting with "A" for the row closest to the stage in each section and working through the alphabet to the rear of the auditorium.
- Seats are numbered sequentially from right to left as you look at the stage. All rows start with seat number 101.

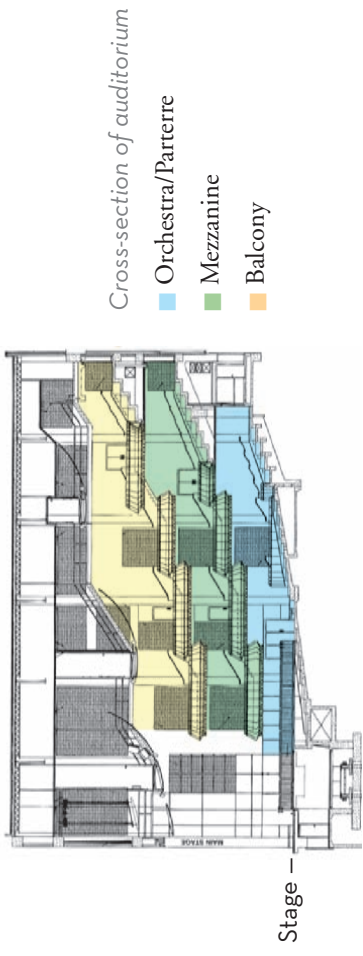

Cross-section of auditorium

- Orchestra/Parterre
- Mezzanine
- Balcony

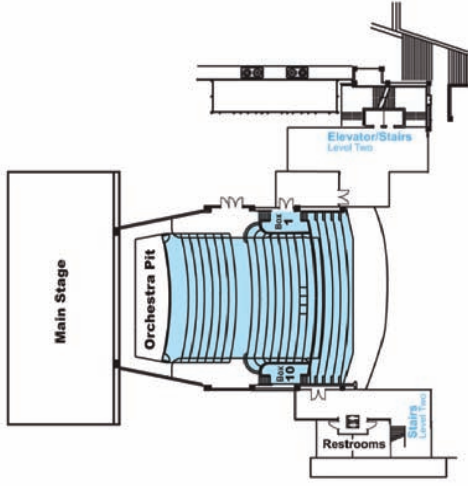

Orchestra/Parterre

- The lowest level of the auditorium
- Primary access: levels one and two of the Ford Center

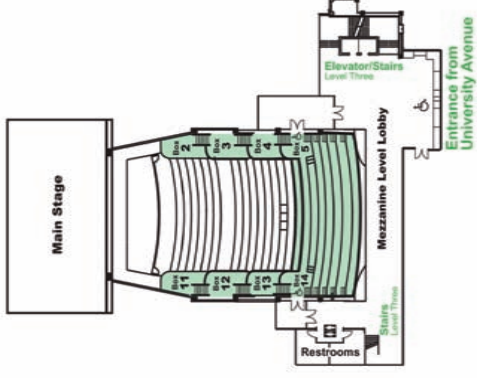

Mezzanine

- Above the parterre level
- Primary access: level three of the Ford Center (University Avenue lobby)

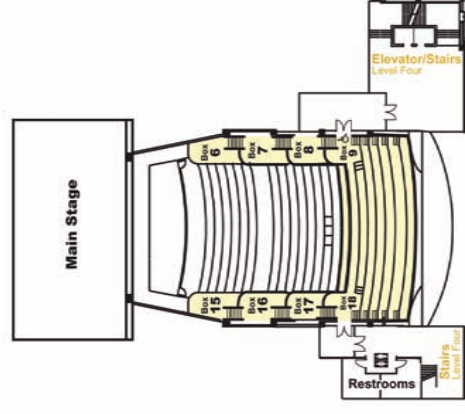

Balcony

- Above and slightly behind the mezzanine
- Primary access: level four